



**Characteristics:**



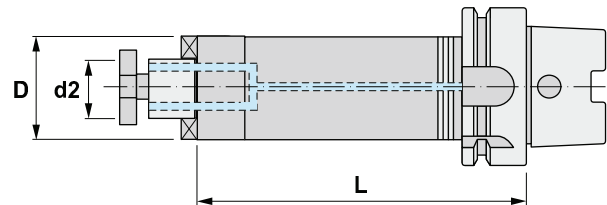

Cylindrical antivibratory shell mill adaptors.  
DIN 69893-1 / HSK Form A  
For cutters with driving slot DIN 138.  
With internal coolant.

**Característiques:**

Con portafreses antivibratori cilíndric.  
DIN 69893-1 / HSK Forma A  
Per freses amb xaveta frontal DIN 138.  
Amb refrigeració interior.



## A16.160IK

Reference Referència	HSK	L	D	d2				
A16.160.063.16/200-38IK	63	200	38	16	10008	86016	11103	2,150
A16.160.063.16/300-38IK	63	300	38	16	10008	86016	11103	3,000
A16.160.063.22/200-48IK	63	200	48	22	10010	86022	11004	3,100
A16.160.063.22/300-48IK	63	300	48	22	10010	86022	11004	4,480
A16.160.063.27/300-58IK	63	300	58	27	10012	86027	11005	4,230
A16.160.100.16/200-38IK	100	200	38	16	10008	86016	11103	3,580
A16.160.100.16/300-38IK	100	300	38	16	10008	86016	11103	4,430
A16.160.100.22/200-48IK	100	200	48	22	10010	86022	11004	4,510
A16.160.100.22/300-48IK	100	300	48	22	10010	86022	11004	5,890
A16.160.100.27/200-58IK	100	200	58	27	10012	86027	11005	5,630
A16.160.100.27/300-58IK	100	300	58	27	10012	86027	11005	7,640
A16.160.100.32/300-78IK	100	300	78	32	10016	86032	11105	10,210



**Characteristics:**

Cylindrical antivibratory shell mill adaptors.  
 DIN 69893-1 / HSK Form A  
 For cutters with driving slot DIN 138.

**Característiques:**

Con portafreses antivibratori cilíndric.  
 DIN 69893-1 / HSK Forma A  
 Per freses amb xaveta frontal DIN 138.

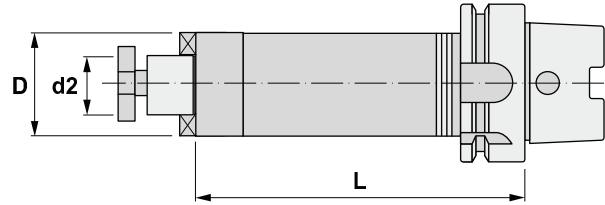

## A16.160

Reference Referència	HSK	L	D	d2				
A16.160.063.16/200-38	63	200	38	16	10008	86016	11103	2,150
A16.160.063.16/300-38	63	300	38	16	10008	86016	11103	3,000
A16.160.063.22/200-48	63	200	48	22	10010	86022	11004	3,100
A16.160.063.22/300-48	63	300	48	22	10010	86022	11004	4,480
A16.160.063.27/200-58	63	200	58	27	10012	86027	11005	4,230
A16.160.063.27/300-58	63	300	58	27	10012	86027	11005	5,340
A16.160.100.16/200-38	100	200	38	16	10008	86016	11103	3,580
A16.160.100.16/300-38	100	300	38	16	10008	86016	11103	4,430
A16.160.100.22/200-48	100	200	48	22	10010	86022	11004	4,510
A16.160.100.22/300-48	100	300	48	22	10010	86022	11004	5,890
A16.160.100.27/200-58	100	200	58	27	10012	86027	11005	5,630
A16.160.100.27/300-58	100	300	58	27	10012	86027	11005	7,640
A16.160.100.32/300-78	100	300	78	32	10016	86032	11105	10,210

### SPECIAL FOR MOULD AND DIE MAKERS

Vibration reduced up to 60% compared to any other conventional shell mill adaptor, as they are manufactured with materials and mechanisms having antivibration properties.

### ESPECIAL PER MOTLLISTES

Gràcies a les propietats antivibratories que posseeixen els materials i mecanismes amb els que estan fabricats, la vibració es veu reduïda en un 60% respecte als portafreses convencionals.

### COMPARISON WHEN USING AN ANTIVIBRATORY TOOLHOLDER

### COMPARATIVA UTILITZANT UN CON ANTIVIBRATORI

